



# Park Cabins FLOORPLANS



THE STANDARD BY WHICH OTHERS ARE JUDGED

## JAYCO PARK CABINS - AN INVESTMENT BUILT ON SOLID FOUNDATIONS

As a leading manufacturer of RV's and Park Cabins, you know you're getting innovative designs, quality build and ongoing support when you invest in a Jayco Cabin.

Jayco cabins are found in most parks across Australia, including the three leading holiday chains – Big Four Holiday Parks, Top Tourist Parks and Family Parks of Australia.

Our experience with the RV market has helped Jayco lead the design evolution with most cabins now falling into the three-star plus category. There are two and three bedroom options with shower & toilet facilities. Or you can choose from our top-of-the-range models that feature spas and other luxury appliances.

With a focus on delivering park owners best value for their development dollar, Robert Ensink has headed up Jayco's park cabin operations for over 15 years - creating cabins that are luxurious, comfortable and functional.

Jayco's design team can also work with park operators to create cabins that are built to an agreed theme and budget.

Jayco cabins usually come fully furnished, with lounge settee, table, chairs and beds as well as curtains and bed covers. Other electrical items such as television sets, DVDs and air conditioners - can also be included.

The cabins are manufactured in a dedicated production plant within the modern Jayco manufacturing complex in the outer eastern Melbourne suburb of Dandenong. Some cabin models are able to be freighted two to a truck, lowering your transport costs. Once at the park it usually only takes minimal site work such as connecting to electricity and plumbing to have the cabin installed.



# Park Cabins

## 20' SERIES

**20' x 11' - No.1 Cabin (6096mm x 3206mm)**  
Code: 20P1001

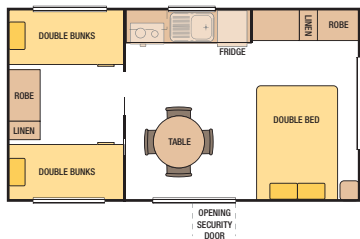

## 21' SERIES

**21' x 11' - No.1 Cabin (6400mm x 3352mm)**  
Code: 21P1001

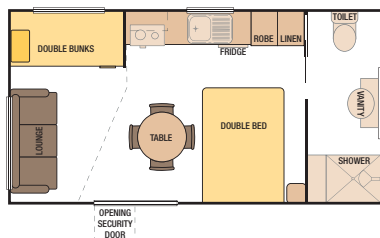

## 22' SERIES

**22' x 13' - No.1 Cabin (6706mm x 3962mm)**  
Code: 22P1001

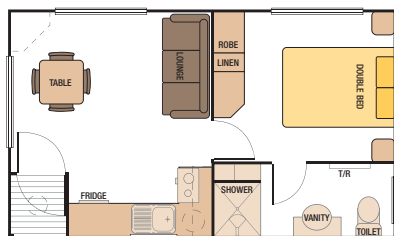

## 23' SERIES

**23' x 11' - No.1 Cabin (6096mm x 3206mm)**  
Code: 23P1001

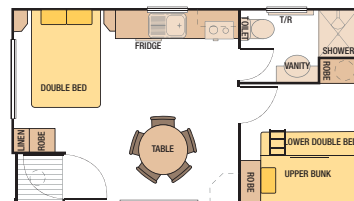

**23' x 14' - No.2 Cabin (7010mm x 4300mm)**  
Code: 23P1002

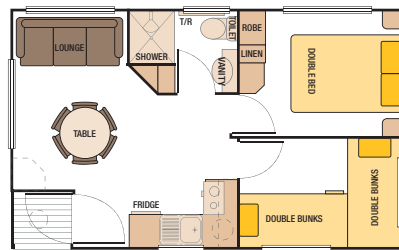

**23' x 14' - No.3 Cabin (7010mm x 4300mm)**  
Code: 23P1003

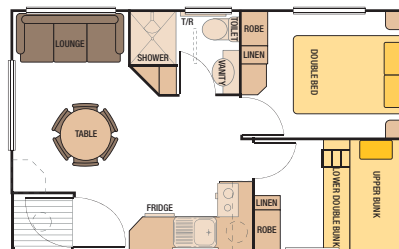

## 23'6" SERIES

**23'6" x 15' - No.1 Cabin (7160mm x 4570mm)**  
Code: 236P1001

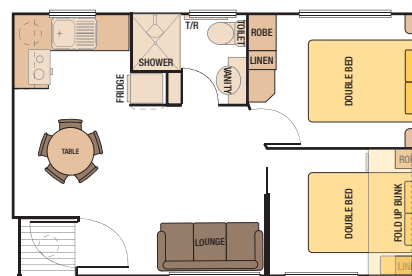

**23'6" x 15' - No.2 Cabin (7160mm x 4570mm)**  
Code: 236P1002

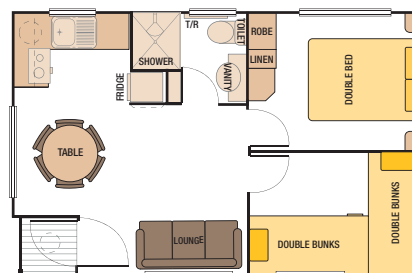

## 25' SERIES

**25' x 11' - No.2 Cabin (7620mm x 3352mm)**  
Code: 25P1001

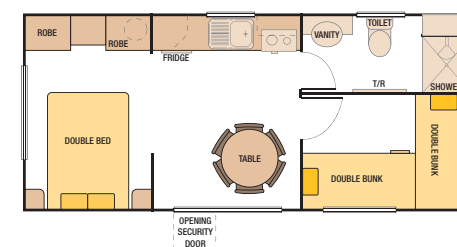

**25' x 11' - No.1 Cabin (7620mm x 3352mm)**  
Code: 25P1002

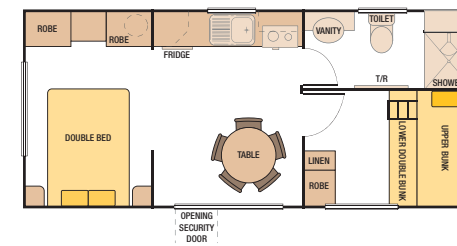

**28' SERIES**

**28' x 13' - No.1 Cabin (8534mm x 3962mm)**  
Code: 28P1001

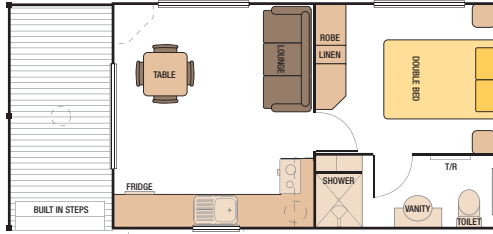

**28' x 15' - No.2 Cabin (8535mm x 4570mm)**  
Code: 28P1002

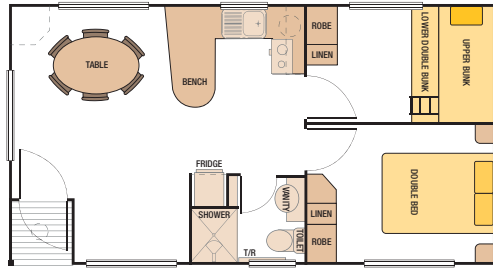

**28' x 15'5' - No.3 Cabin (8534mm x 4700mm)**  
Code: 28P1003

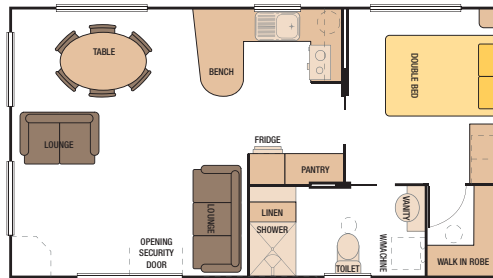

**29' SERIES**

**29' x 13' - No.1 Cabin (8840mm x 3962mm)**  
Code: 29P1001

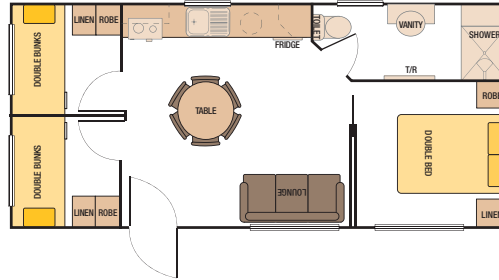

**29' x 14' - No.4 Cabin (8840mm x 4300mm)**  
Code: 29P1002

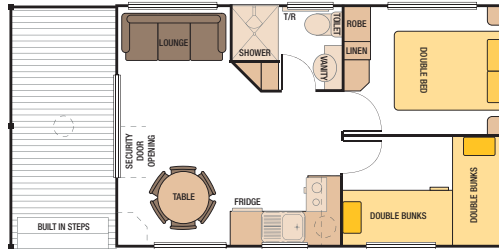

**29' x 14' - No.3 Cabin (8840mm x 4300mm)**  
Code: 29P1003

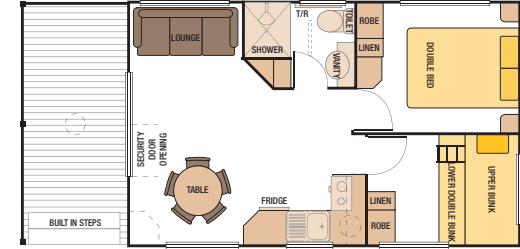

**29' x 14' - No.2 Cabin (8840mm x 4300mm)**  
Code: 29P1004

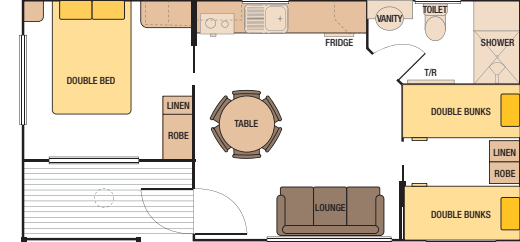

### 30' SERIES

30' x 15' - No.1 Cabin (9144mm x 4570mm)  
Code: 30P1001

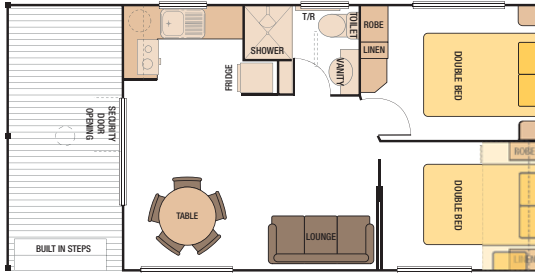

30' x 15' - No.2 Cabin (9144mm x 4570mm)  
Code: 30P1002

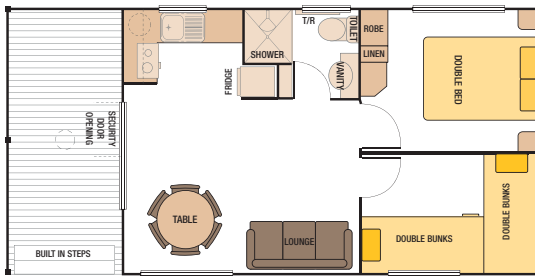

### 34' SERIES

34' x 15' - No.1 Cabin (10350mm x 4570mm)  
Code: 34P1002

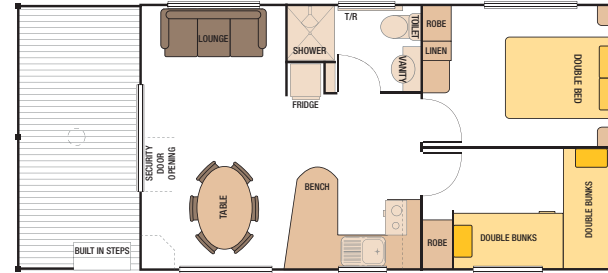

### 36' SERIES

36' x 15' - No.1 Cabin (10935mm x 4570mm)  
Code: 36P1001

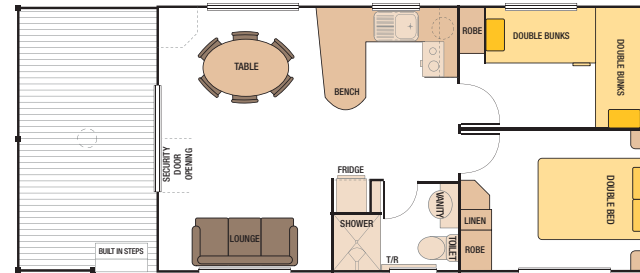

36' x 15'5" - No.2 Cabin (11000mm x 4700mm)  
Code: 36P1002



### 38' SERIES

38' x 15'5" - No.2 Cabin (11582mm x 4700mm)  
Code: 38P1001

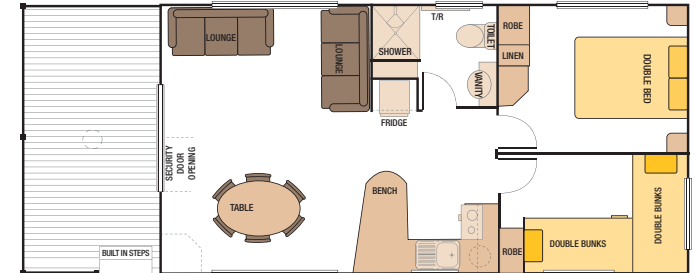

38' x 15'5" - No.3 Cabin (11582mm x 4700mm)  
Code: 38P1002

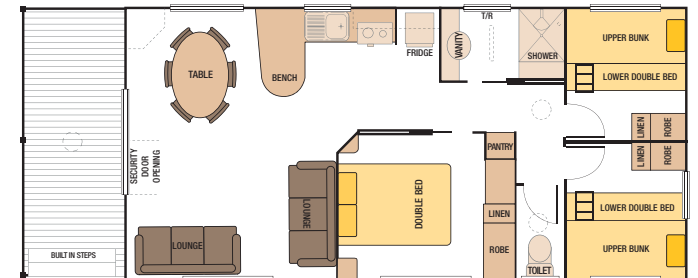

38' x 15' - No.1 Cabin (11582mm x 4570mm)  
Code: 38P1004

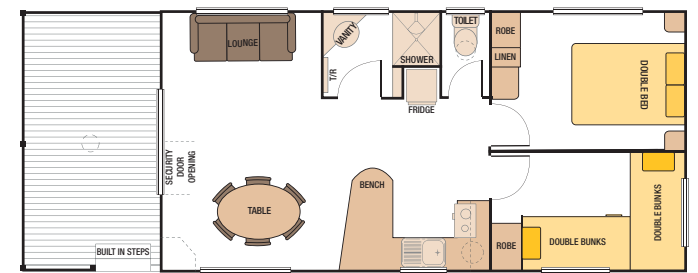

THE STANDARD BY WHICH OTHERS ARE JUDGED

### 39' SERIES

**39' x 15' - No.2 Cabin (11887mm x 4570mm)**  
Code: 39P1001

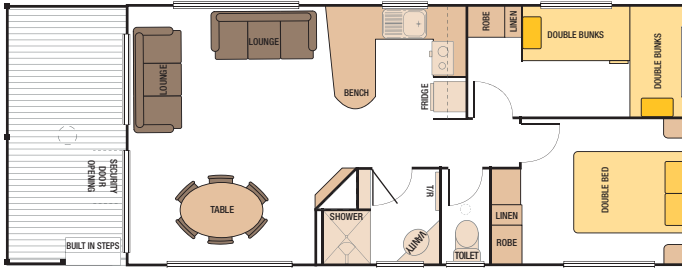

**39' x 15'5" - No.1 Cabin (11887mm x 4700mm)**  
Code: 39P1002

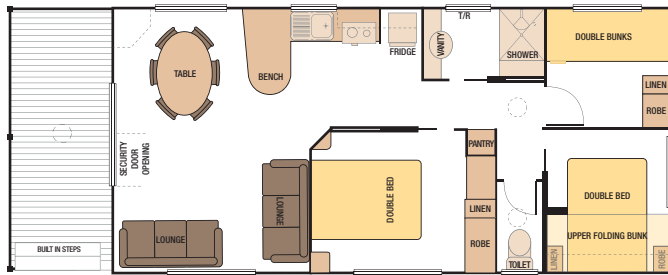

### 42' SERIES

**42' x 15'5" - No.1 Cabin (12800mm x 4700mm)**  
Code: 42P1001

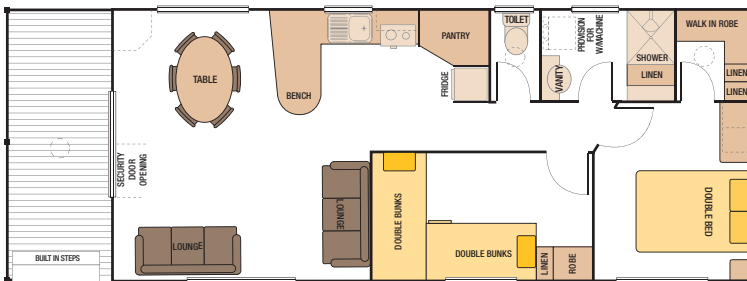

### SPA SERIES

**23' x 14' - Spa No.1 Cabin (7010mm x 4300mm)**  
Code: 23P1004

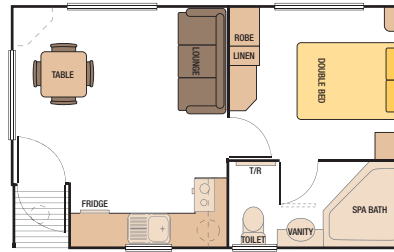

**29' x 14' - Spa No.2 Cabin (8840mm x 4300mm)**  
Code: 29P1005

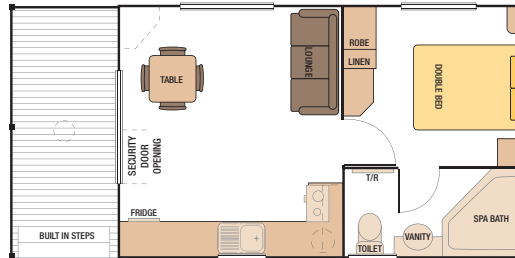

**38' x 15'5" - Spa No.3 Cabin (11582mm x 4700mm)**  
Code: 38P1003

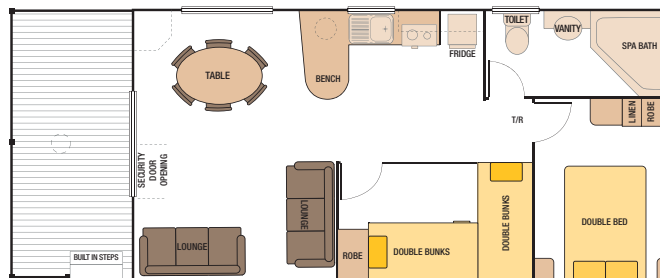

## STANDARD MODEL FEATURES

- 1 Euromaid 2 Burner / oven electric cooker
- 2 Bar refrigerator under bench
- 3 Domestic rangehood vented to exterior
- 4 Table with pedistal Legs and padded chairs
- 5 Lounge settee (2.5 seater)
- 6 Pelmet to windows (Except bunk & ensuite windows)
- 7 Tiled splashback to bench area
- 8 Flick mixer to kitchen sink and ensuite vanity
- 9 Hot and cold mixer tap to shower
- 10 Domestic quality 16mm furniture with timber kickrails
- 11 Laminated bench tops
- 12 Cutlery drawer
- 13 Utensil drawer
- 14 Television / video shelf
- 15 Heavy duty vinyl flooring
- 16 Colour Co-ordinated
- 17 Suede back curtains with metal rings
- 18 Privacy net curtains to all windows (Except ensuite window)
- 19 Timber architraves around all internal doorways and all windows
- 20 Timber skirtings to bottom of walls in all rooms
- 21 Smoke detectors (Hard wired)
- 22 Earth leakage circuit breakers (Safety switches)
- 23 Innerspring mattress to steel framed double bed with suitcase storage under
- 24 Laminated bed heads to double beds
- 25 Two eyelid bunker lights over double bed
- 26 Bedside tables to each side of double bed
- 27 Double power points to double beds
- 28 Bunker light over dressing tables
- 29 Wall mirror over dressing table
- 30 All bunks are welded steel framed, and comply to the Australian Standards
- 31 12 Degree pitched gable roof with flat internal ceiling
- 32 Corrugated color bond roofing
- 33 Ceiling vents in ceiling
- 34 Slotted guttering with two outlet points including downpipes
- 35 Internal ceiling height of 8'0" (2400mm)
- 36 Weatherboard profile external aluminium cladding
- 37 Powder coated domestic quality sliding windows with rollers with removable flyscreens
- 38 Security doors
- 39 Exterior light on standard switch
- 40 Full fiberglass insulation in walls and ceiling
- 41 Axles, wheels and detachable draw bar

## STANDARD FEATURES ON ENSUITE MODELS

- 1 Full height moulded shower recess with child hip bath, high front and soap holder
- 2 Shower curtain
- 3 Vitreous China semi recessed vanity with overflow
- 4 Down light above vanity
- 5 Vanity cupboard with timber kick rail
- 6 Tiled splash back to vanity cupboard
- 7 50 litre Electric hot water service
- 8 Hot and cold water to sink ,vanity and shower
- 9 Exhaust fan (Wired directly to light switch)
- 10 Dual flush toilet
- 11 Toilet roll holder
- 12 Two coat hooks on back of ensuite door
- 13 Double towel rail
- 14 Mirror and power point fitted above vanity
- 15 1 row of tiles around bottom of ensuite walls



## OPTIONAL EXTRAS AVAILABLE

- 1 Larger 2 door refrigerator
- 2 Domestic 4 burner / griller /oven (LPG or Nat Gas)
- 3 Domestic 4 burner /oven electric
- 4 Domestic 4 burner hot plate (LPG or Nat Gas)
- 5 Exterior gas hot water service (LPG or Nat Gas)
- 6 Microwave oven
- 7 Dishwashers
- 8 Ceiling fans
- 9 Wall fans
- 10 Exterior power points
- 11 Cooling only air conditioning
- 12 Reverse Cycle air conditioning
- 13 Split System air conditioning
- 14 Alpha Pure Heat electric recessed wall heater
- 15 Clock radio
- 16 Key tag switch
- 17 Hair dryer
- 18 Televisions
- 19 Hinged glass shower door
- 20 Sliding glass shower doors
- 21 Ceiling light / heater in ensuite
- 22 Ensemble double or queen bed
- 23 Drawers under bunks
- 24 Drawers under dressing table
- 25 Full height mirrors (1550mm x 500mm)
- 26 Full height wardrobes
- 27 Bunker lights to bunks
- 28 Lounge settee with pull out bed (2.5 seater)
- 29 Lounge settee no bed (2 seater)
- 30 18 Degree pitched gable roofs
- 31 Cathedral ceilings
- 32 Frett work and finials
- 33 2 Tread steps
- 34 Dura-Gal chassis painted black
- 35 Hot dipped galvanised chassis
- 36 Exterior cladding options in cedar, weathertex, mini-orb
- 37 Corrugated Iron and vinyl Weatherboards
- 38 Carpet
- 39 Internal dado wall linings 900mm and 1200mm high
- 40 Plasterboard wall linings

(With our policy of continual product research and on-going development and improvements, all specifications and layouts contained herein are subject to change without notice - Floor Plans shown within this brochure are not necessarily to scale.)

THE STANDARD BY WHICH OTHERS ARE JUDGED



For more information on our extensive range of Park Cabins please contact:  
Robert Ensink email › [robert.ensink@jayco.com.au](mailto:robert.ensink@jayco.com.au)

**Jayco Corporation Pty Ltd**  
ACN 005 266 991  
ABN 79 301 936 497

1 Jayco Drive  
Dandenong South  
Victoria Australia 3175

**Telephone** 03 8792 2000  
**Facsimile** 03 8792 2193  
**Web** [www.jayco.com.au](http://www.jayco.com.au)



THE STANDARD BY WHICH OTHERS ARE JUDGED